

Replacement of the wheel



1. Remove the little cap.



2. Remove the aranlock and the washer.



3. Remove the hubcap.



4. Remove the wheel and replace with a new one. Re-assemble in reverse order.

Replacement of the button switch



1. Unscrew the 2 screws and remove the accelerator rubber.



2. Remove the accelerator button.



3. Remove the button switch.

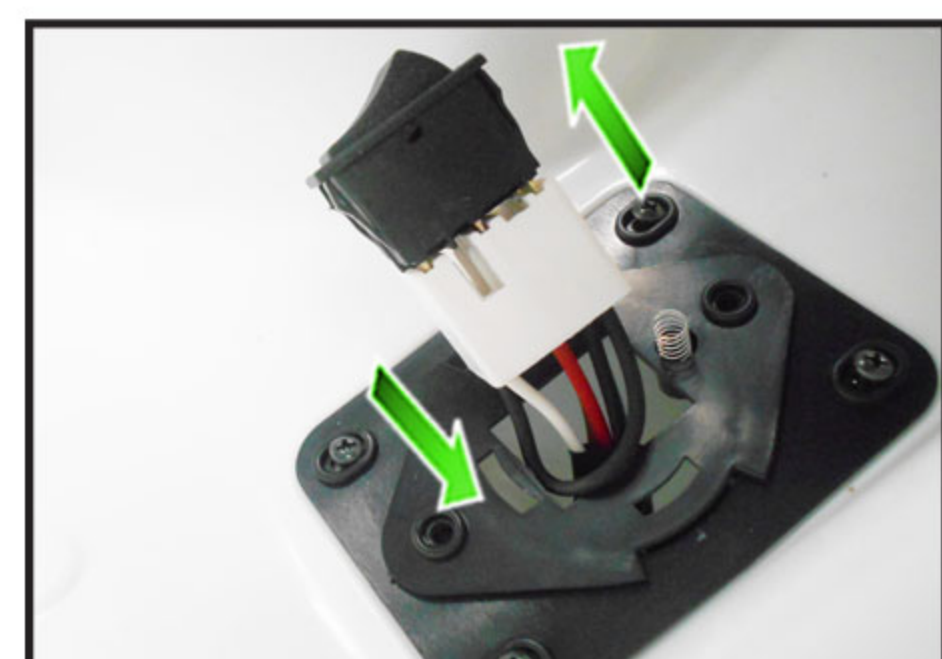

4. Disconnect the wires and replace it with a new one. Re-assemble in reverse order.

Note: Pay attention on connecting the button switch and the wires in the correct way.

Replacement of the mechanism



1. Remove the little cap.



2. Remove the aranlock and the washer.



3. Remove the hubcap.



4. Remove the wheel and replace with a new one. Re-assemble in reverse order.

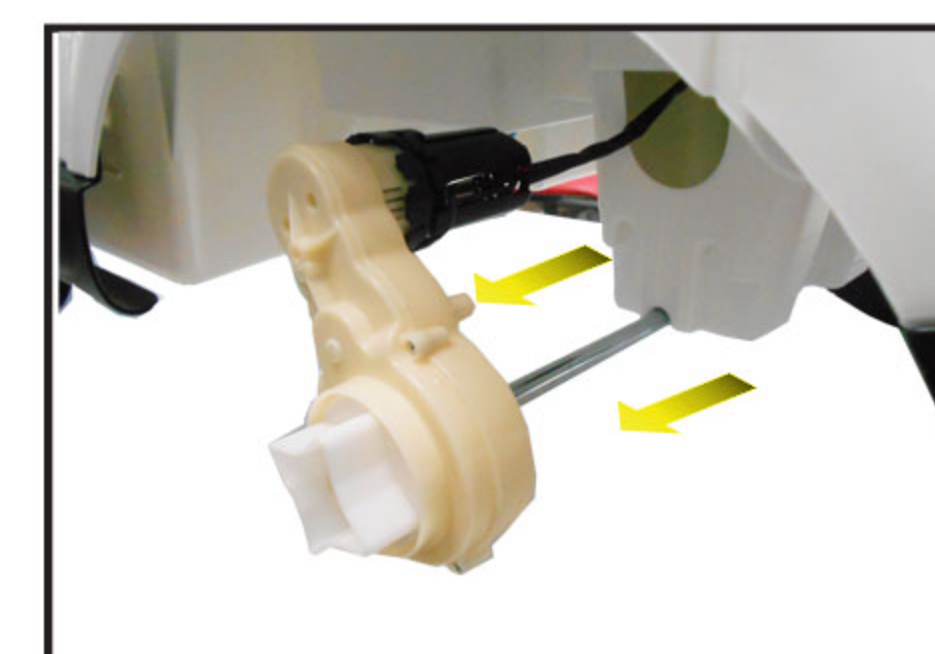

5. Pull out the axle and remove the mechanism.

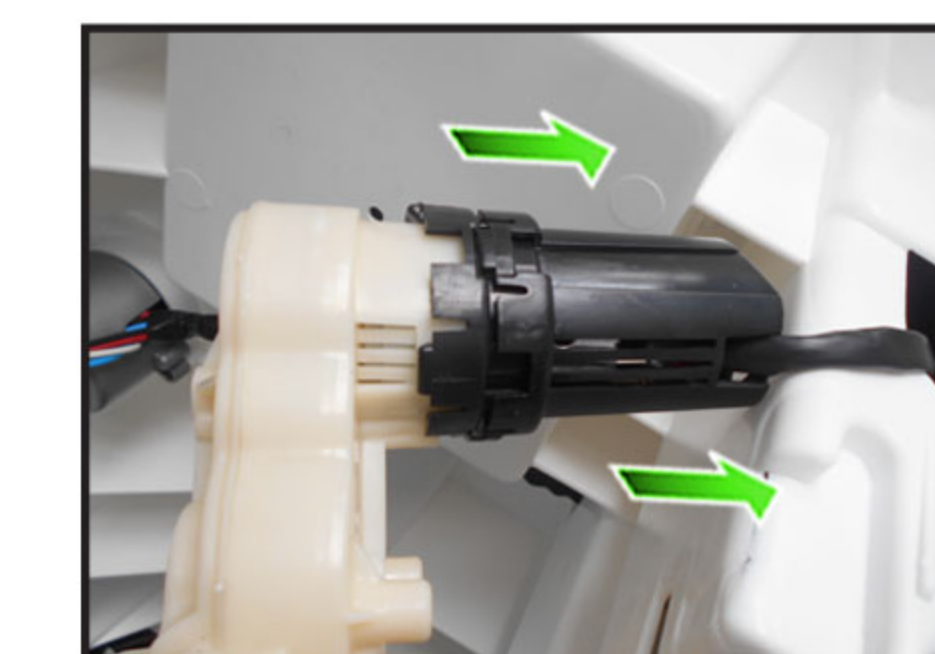

6. Remove the black cover of the mechanism.

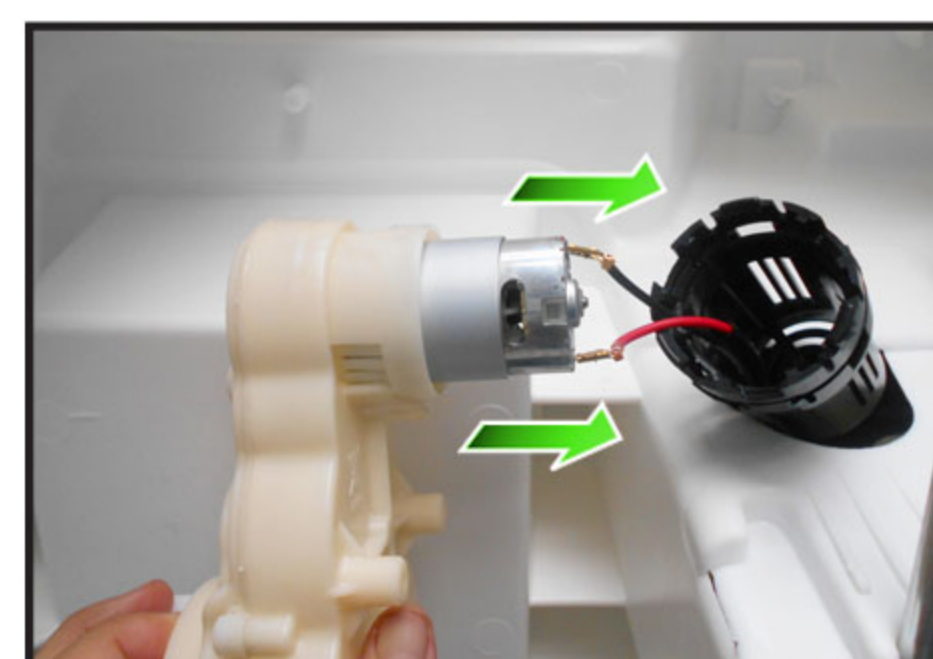

7. Disconnect the wires of the mechanism to replace it with a new one. Re-assemble in reverse order.

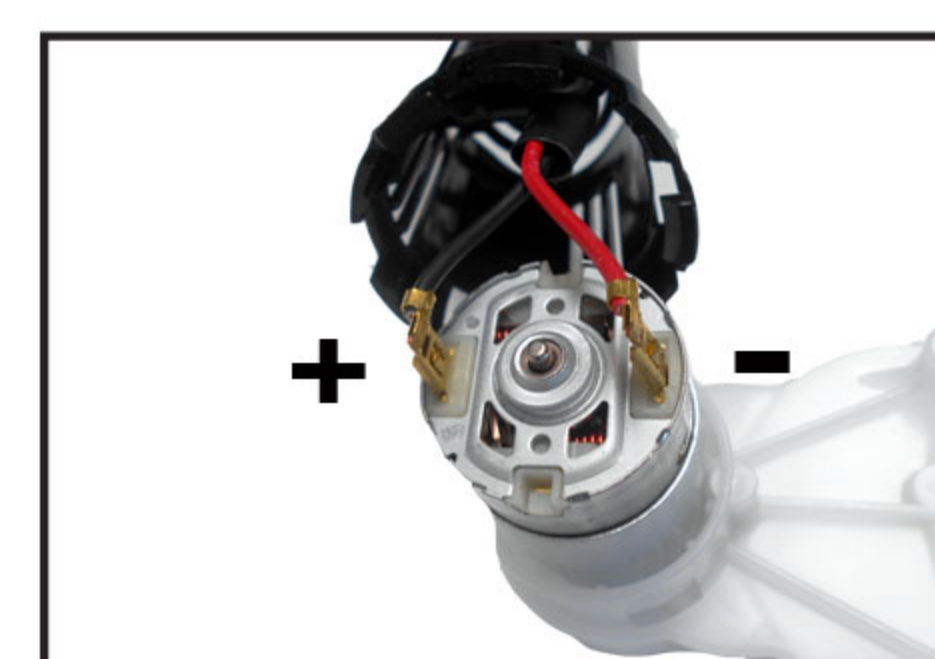

Note: Connect the wires in same polarity order of the previous mechanism.

Replacement of the battery

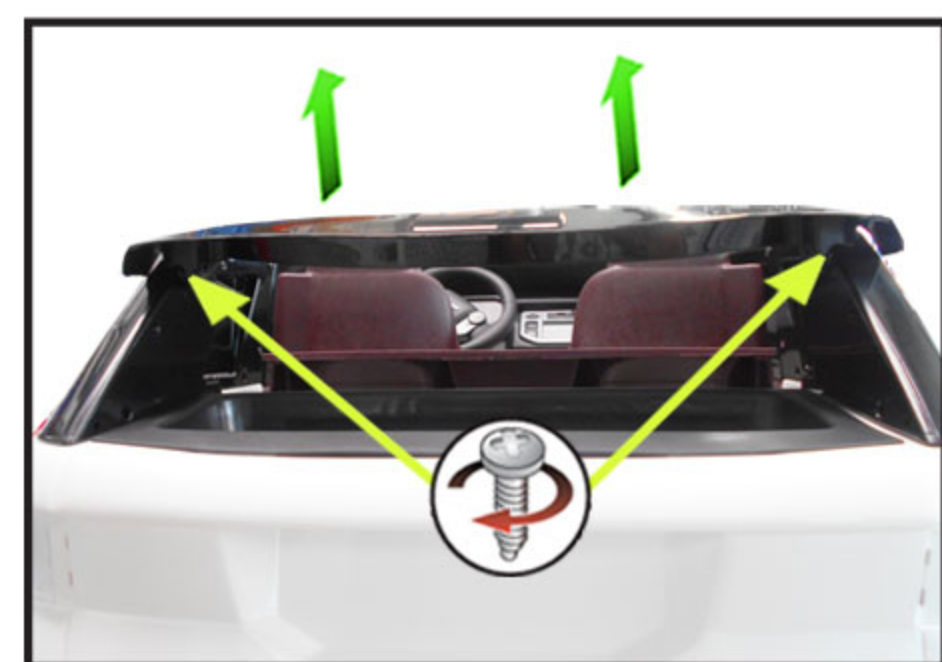

1. Unscrew the back spoiler and remove it.

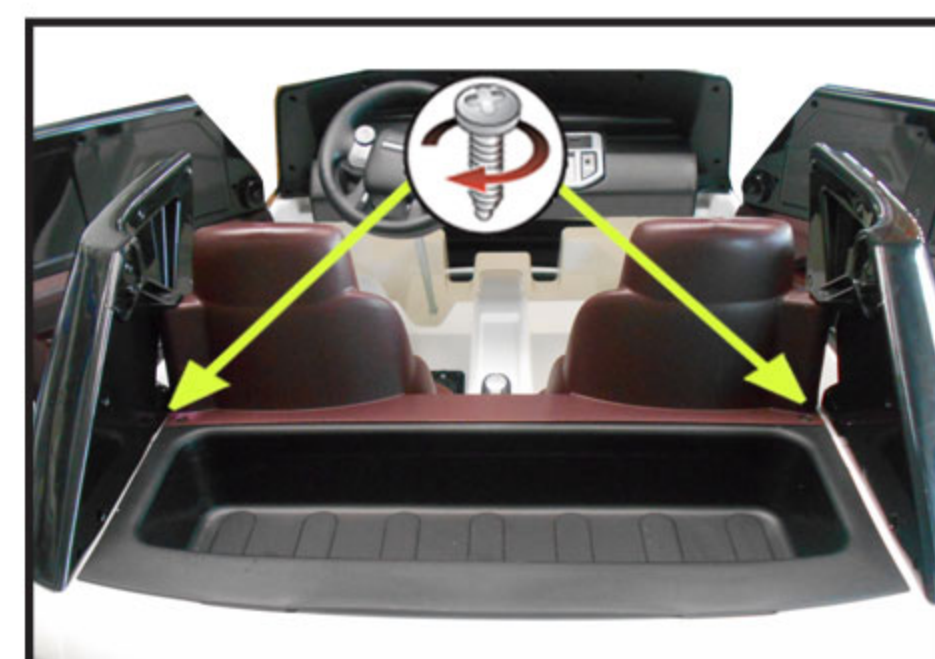

2. Unscrew the back side of the seats.



3. Unscrew the front side of the seats and remove them.

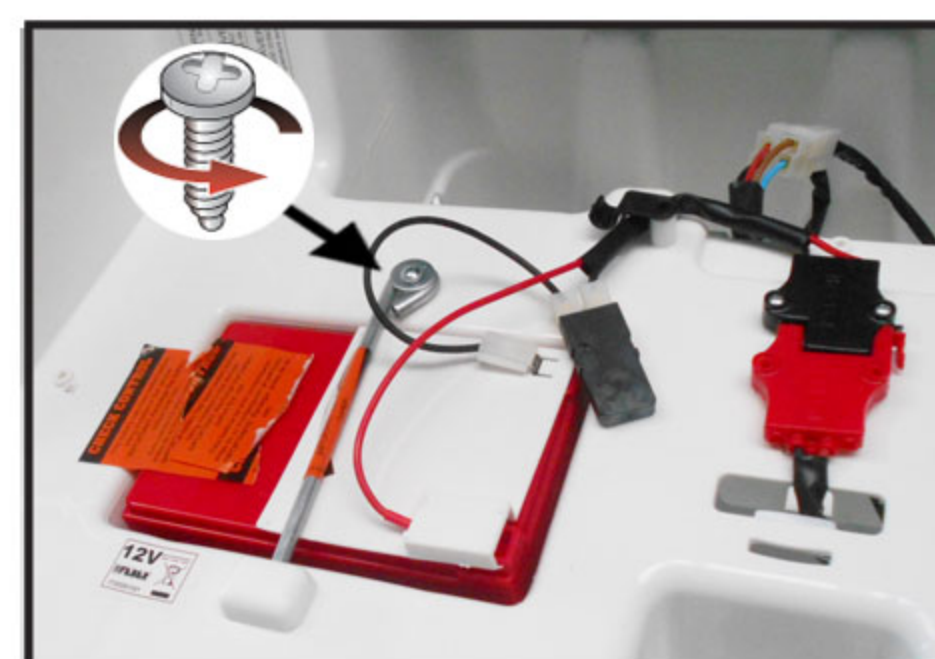

4. Unscrew the shaft and remove it.



5. Disconnect the wires from the battery.



6. Remove the battery and replace with a new one. Re-assemble in reverse order and pay attention to connecting the wires to the proper polarity.

Replacement of the charge wiring.

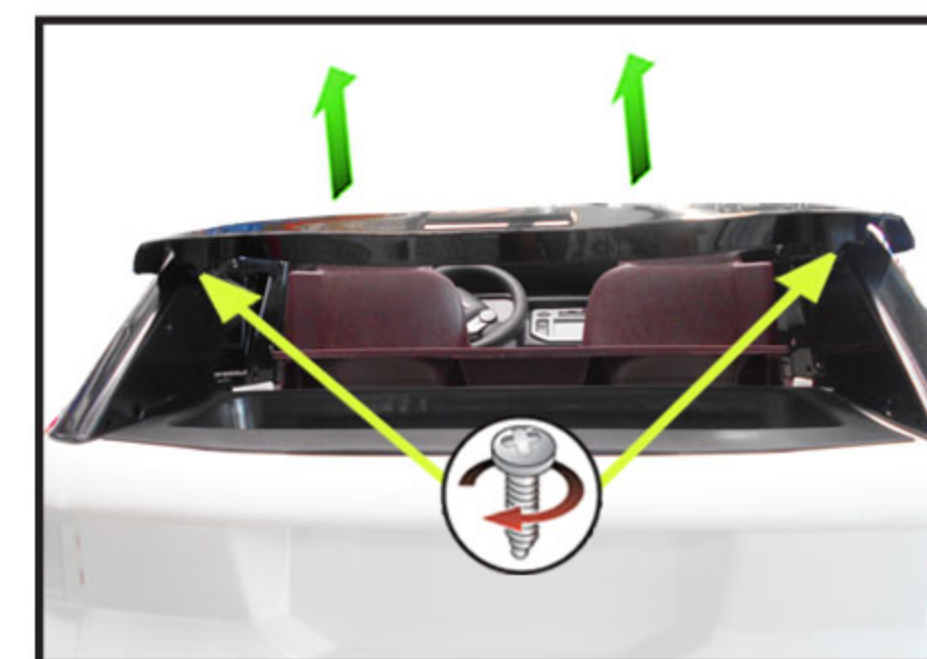

1. Unscrew the back spoiler and remove it.

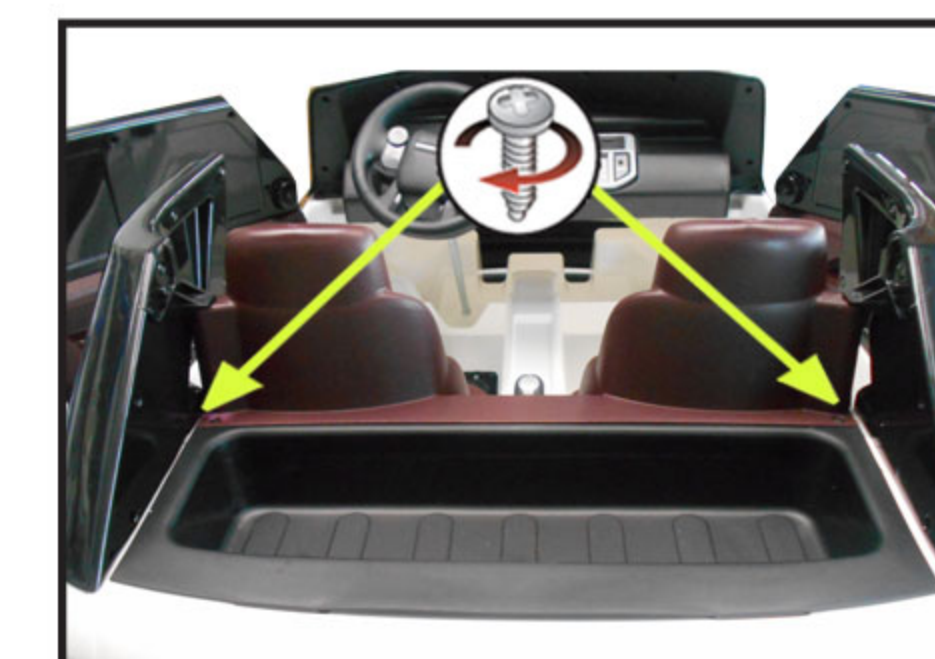

2. Unscrew the back side of the seats.

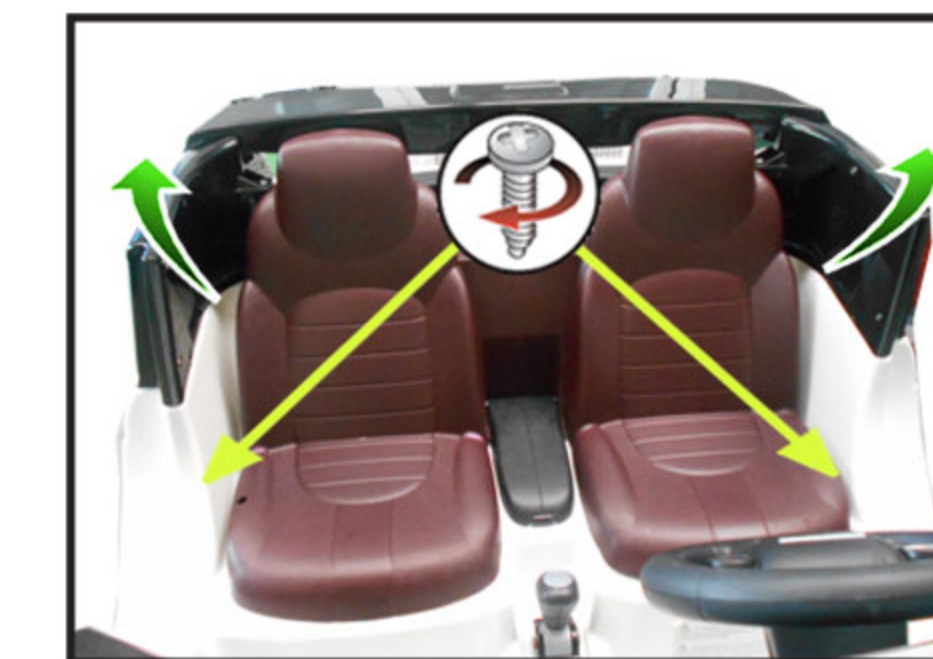

3. Unscrew the front side of the seats and remove them.

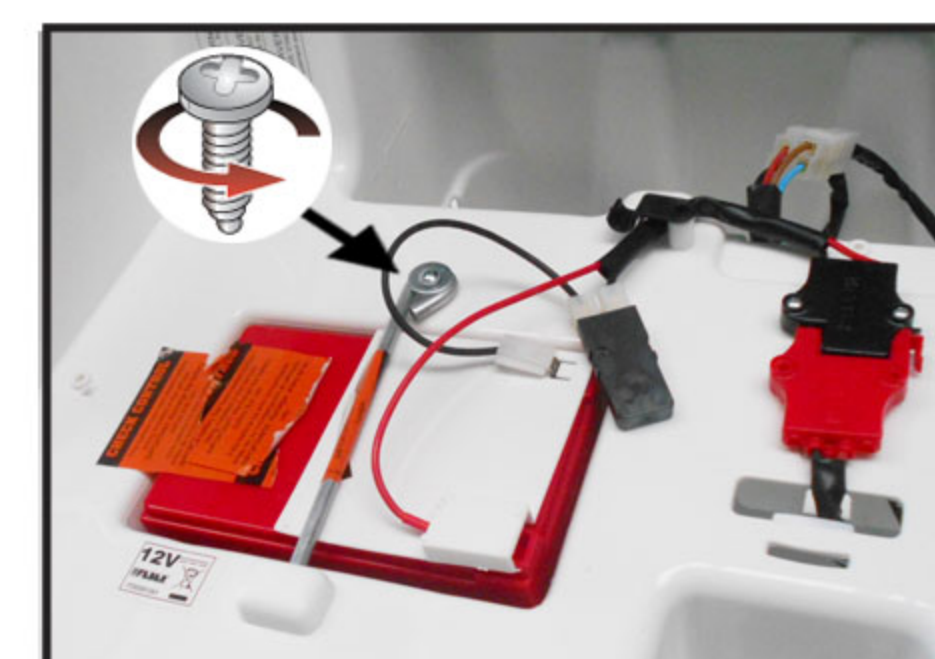

4. Unscrew the shaft and remove it.



5. Disconnect the wires from the battery.

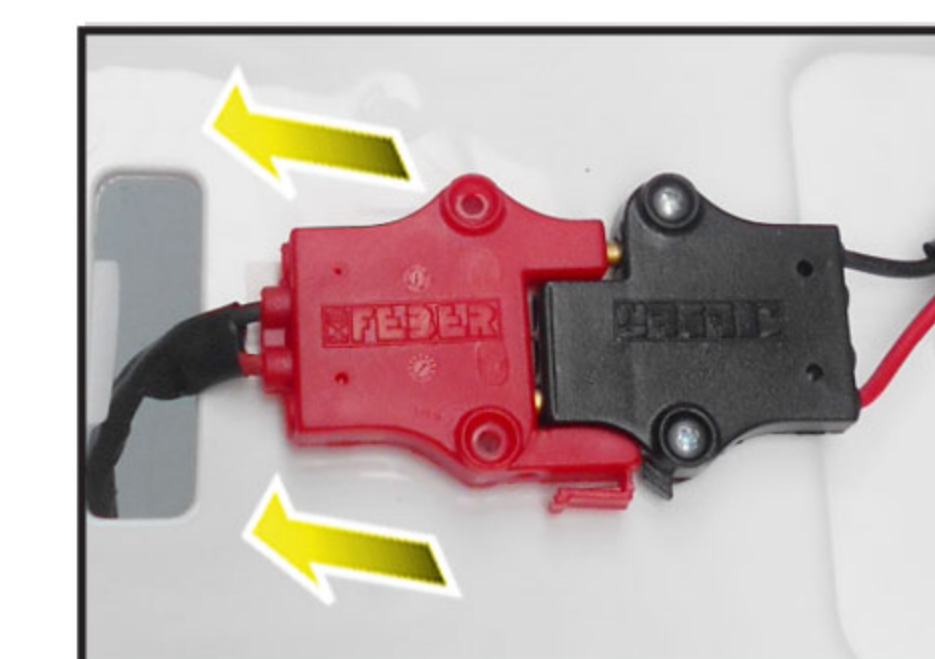

6. Disconnect the red wire and replace the charge wiring with a new one. Re-assemble in reverse order.

Replacement of the circuit breaker

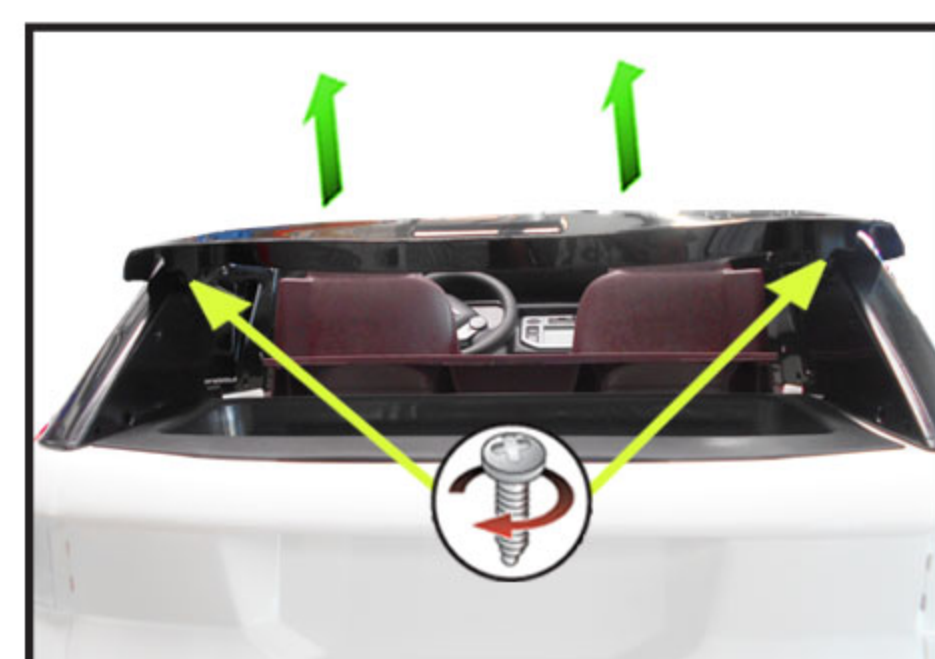

1. Unscrew the back spoiler and remove it.

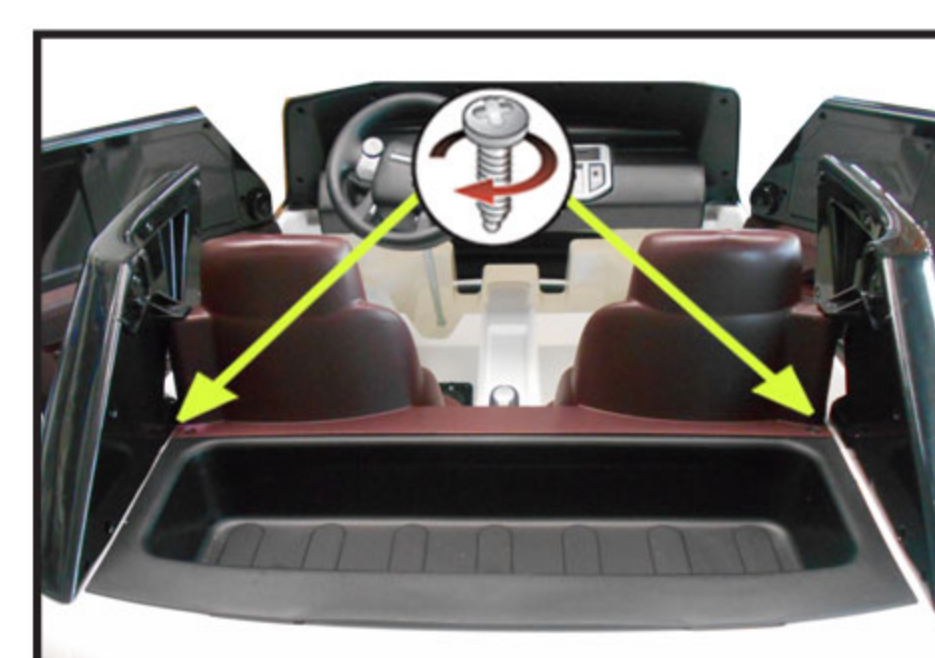

2. Unscrew the back side of the seats.



3. Unscrew the front side of the seats and remove them.

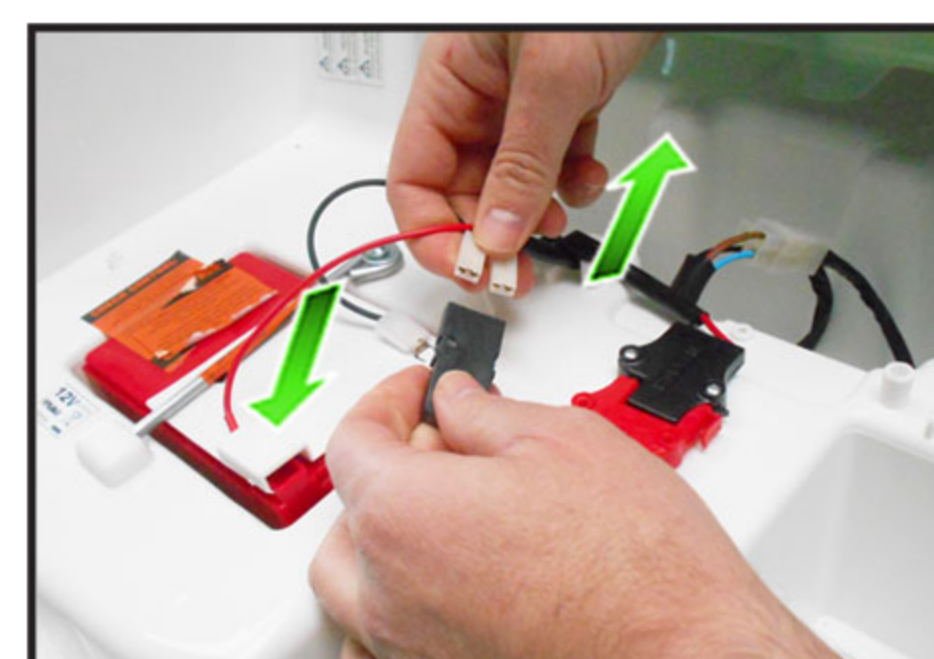

4. Remove the circuit breaker.

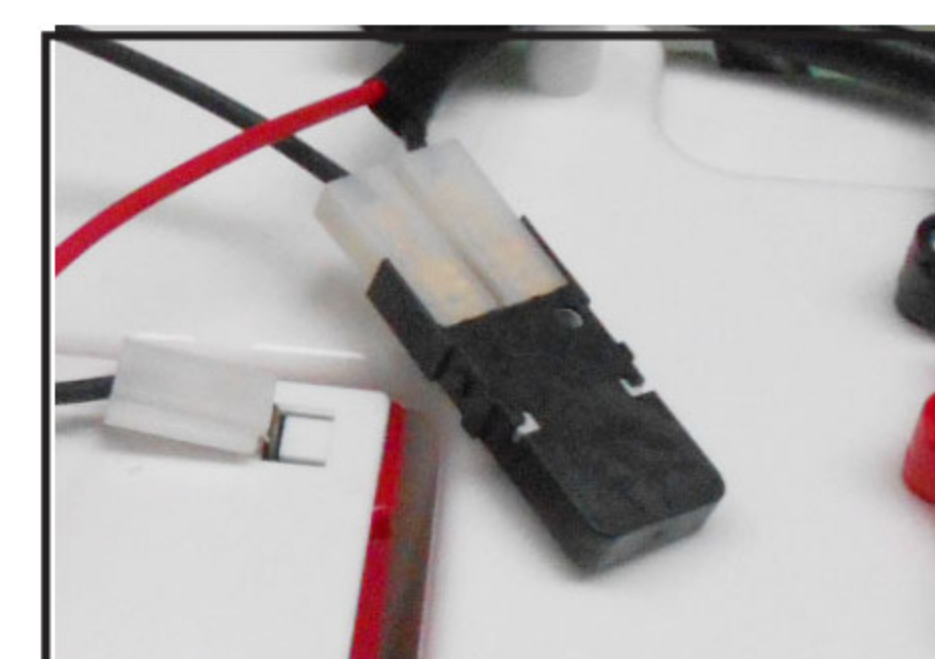

5. Replace with the new one and re-assemble in reverse order.

Replacement of the windshield

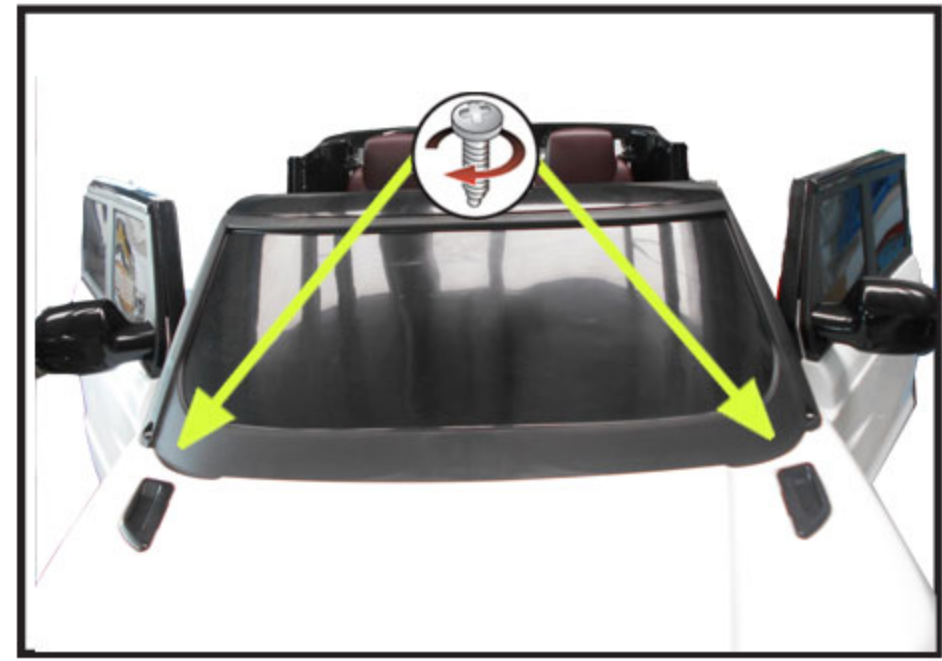

1. Unscrew the front side of the windshield



2. Unscrew the steering wheel.



3. Unscrew the back side of the windshield.



4. Find the flaps under the windshield.



5. Release the windshield pushing the flaps out.



6. Remove the windshield and replace with a new one. Re-assemble in reverse order.

Replacement of the gear stick



1. Unscrew the gear stick.

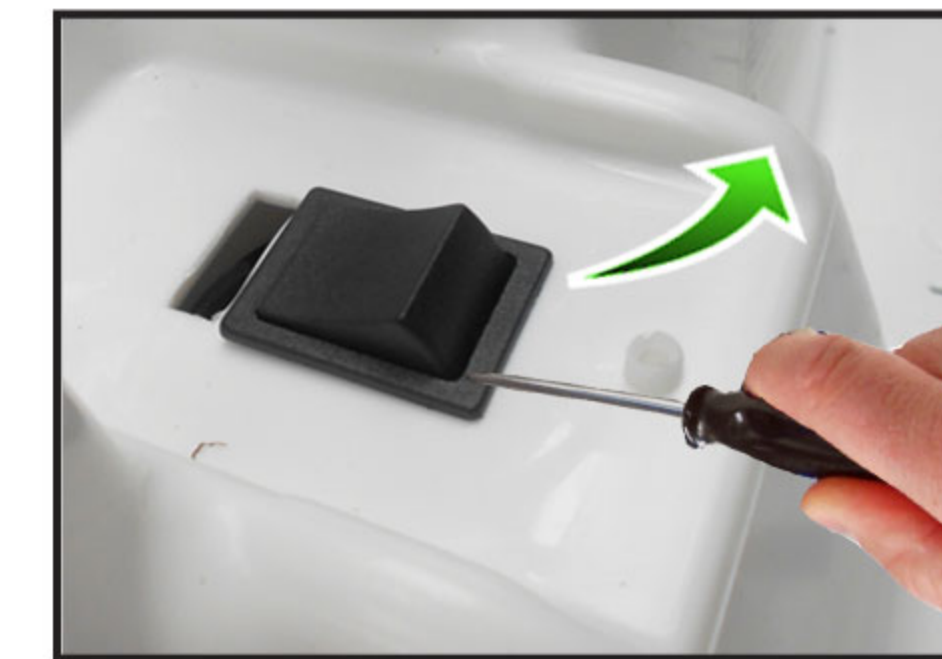

2. Remove the switch.

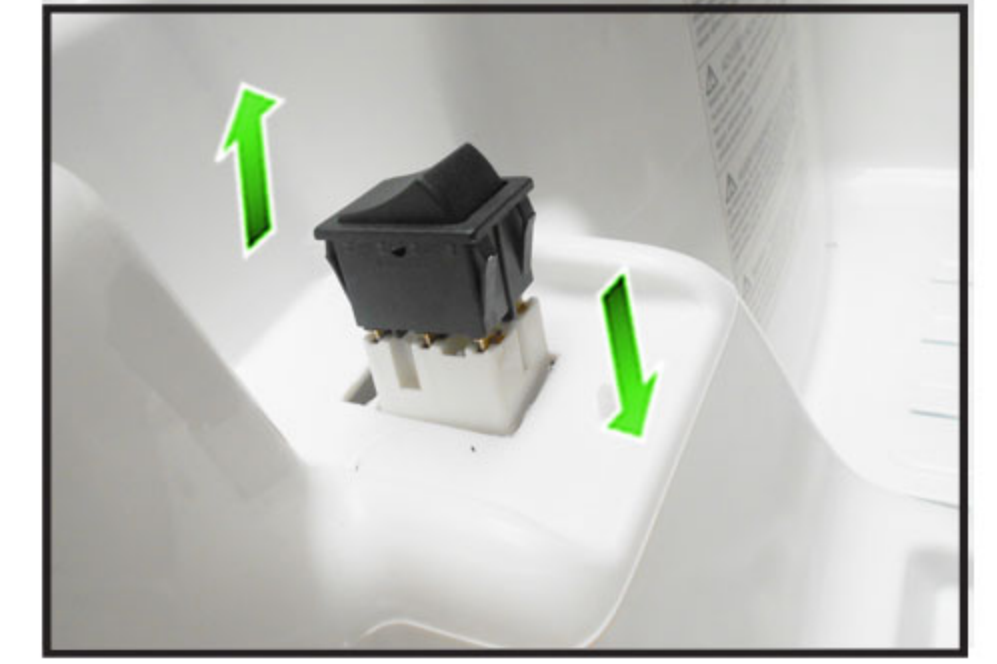

3. Disconnect the switch and replace it with a new one. Re-assemble in reverse order. Pay attention to connecting the button switch and the wires in the correct way.

Replacement of the button switch



1. Remove the sound system from the car.



1. Replace with a new one.