

## Replacement of the wheel



1. Remove the axle lock and the washer.



2. Remove the hubcap.

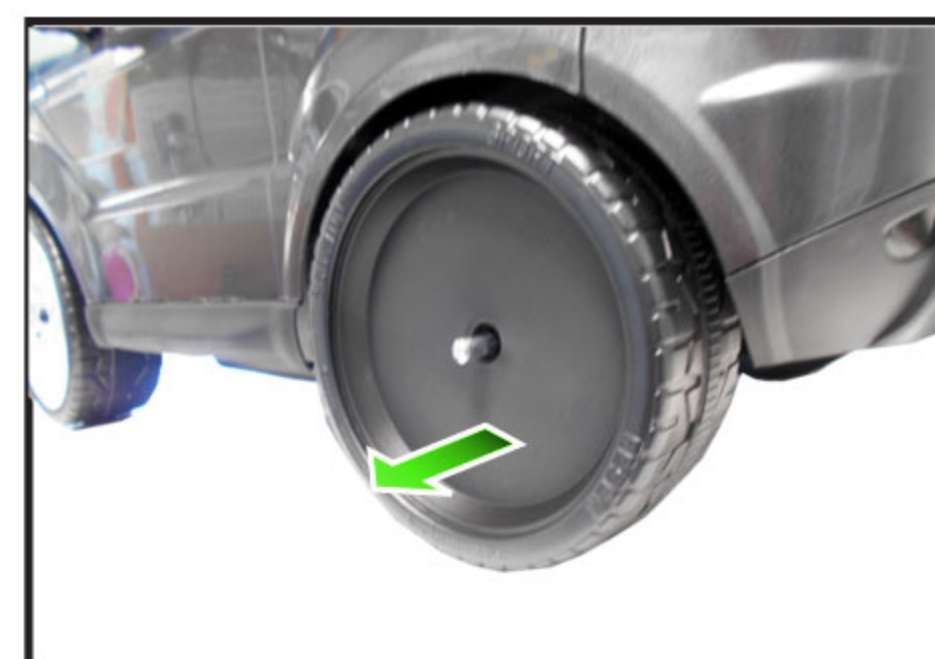

3. Remove the wheel and replace with a new one. Re-assemble in reverse order.

## Replacement of the mechanism



1. Remove the axle lock and the washer.



2. Remove the hubcap.

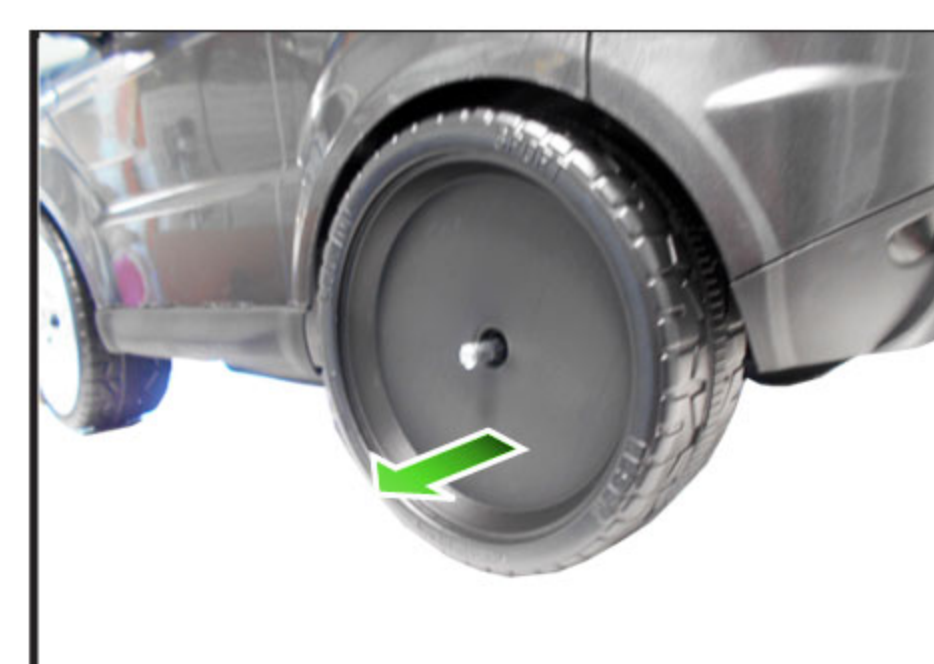

3. Remove the wheel and replace with a new one.

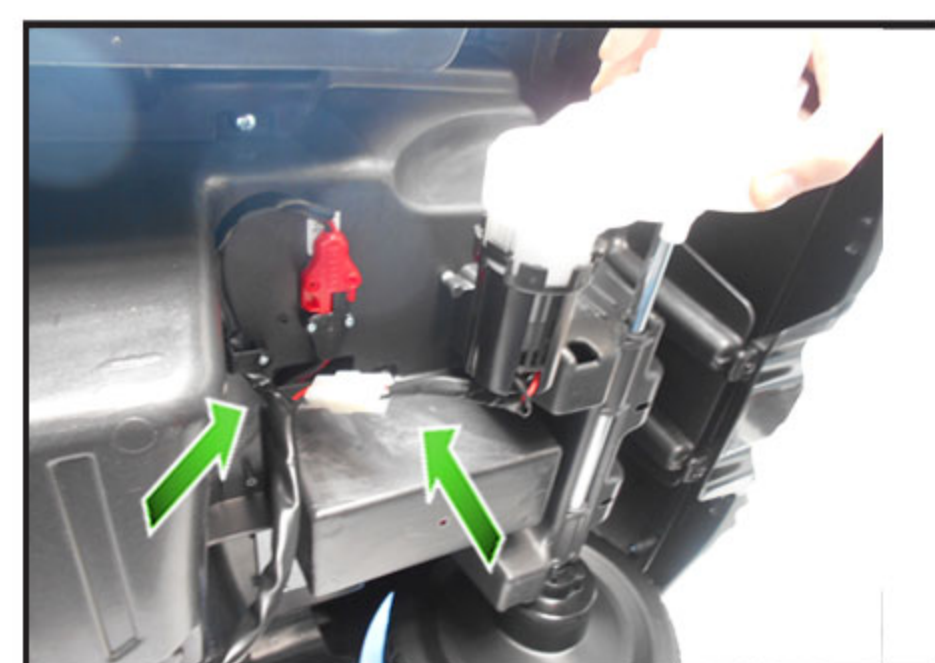

4. Turn 180° and disconnect the wires.



5. Remove the mechanism.

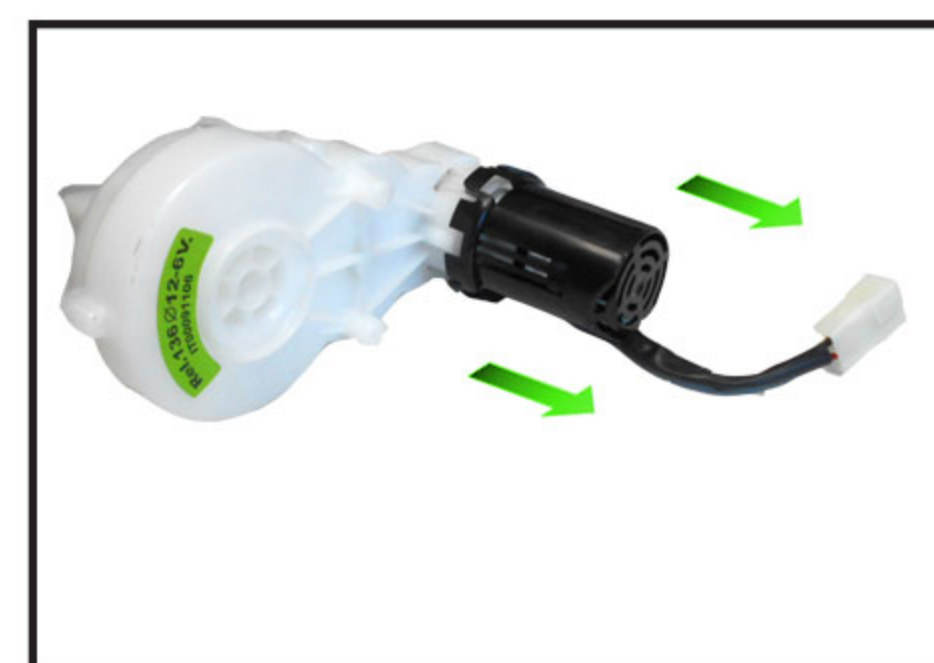

6. Remove the black cover of the mechanism.

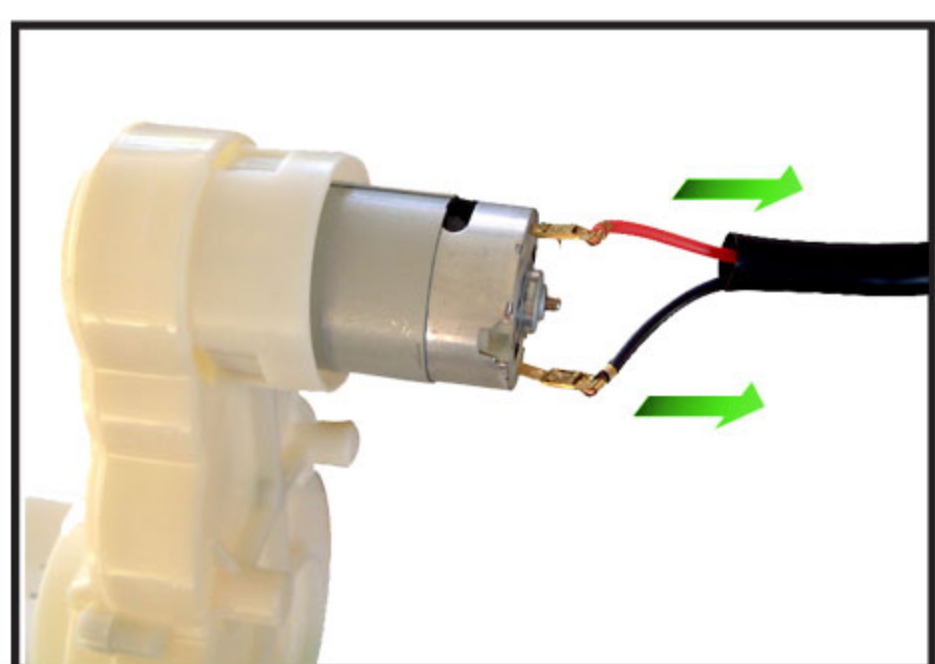

7. Disconnect the wires of the mechanism to replace it with a new one. Re-assemble in reverse order.

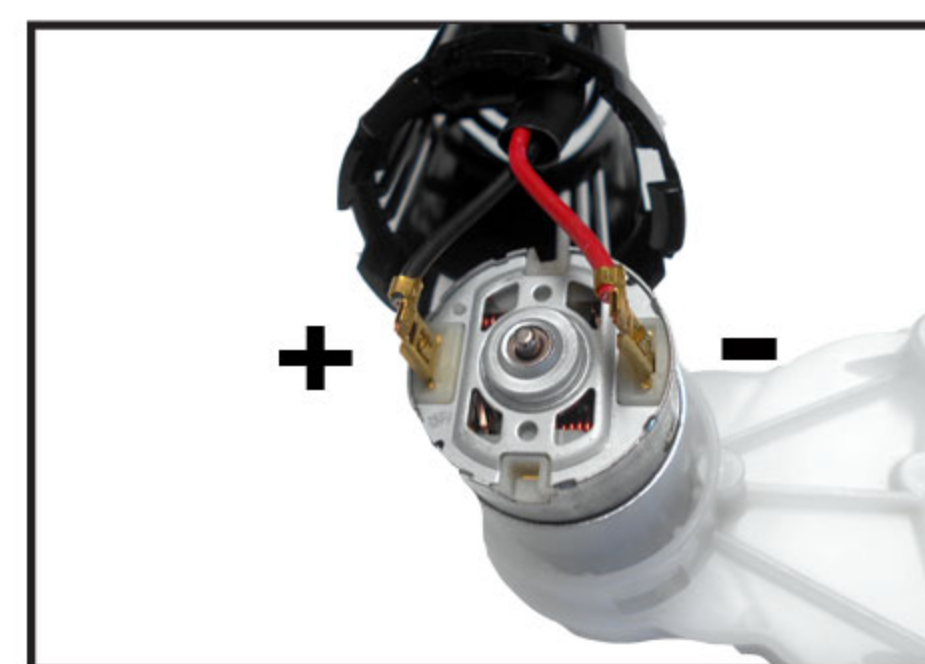

Note: Connect the wires in same polarity order of the previous mechanism.

## Replacement of the battery



1. Unscrew the 2 screws from the seat.

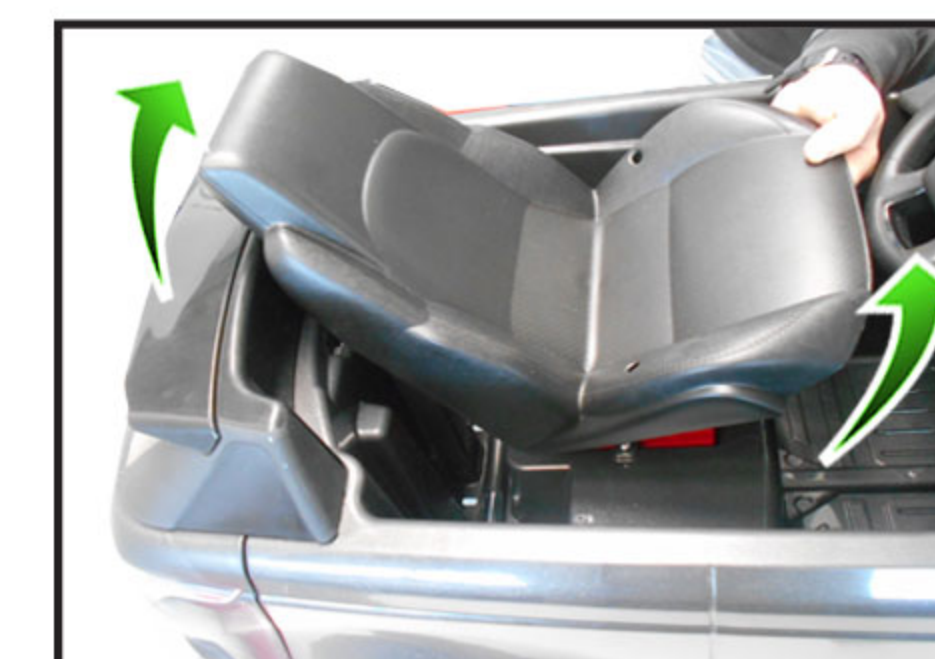

2. Remove the seat.

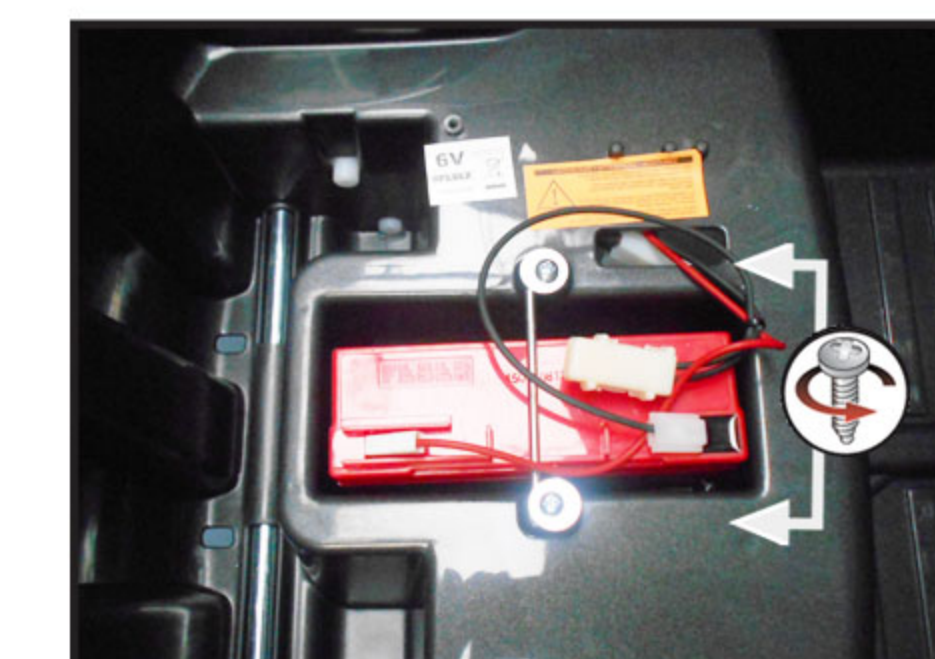

3. Unscrew the axle to remove the battery.

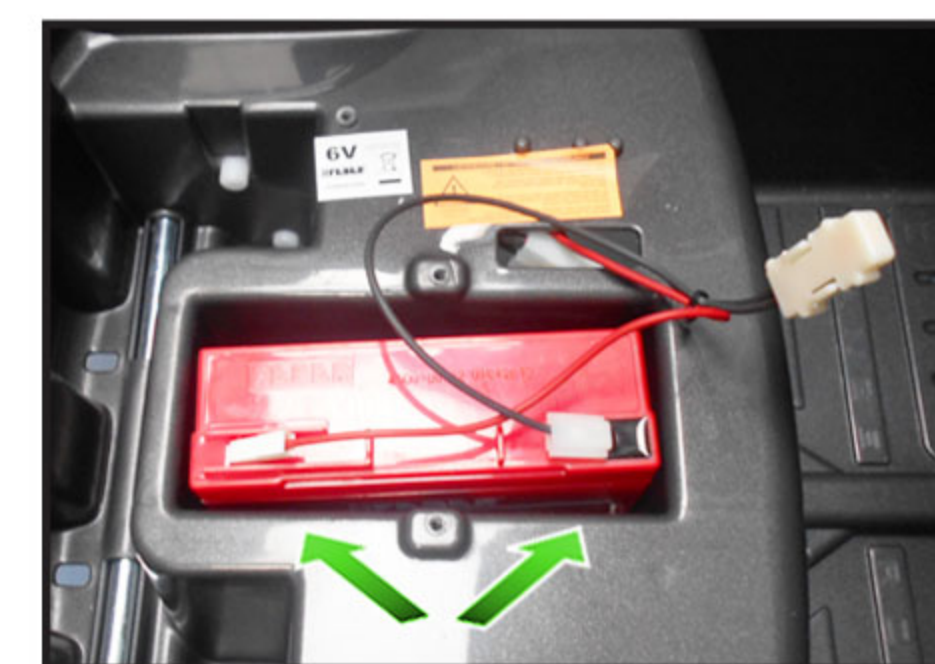

4. Disconnect the wires from the battery.

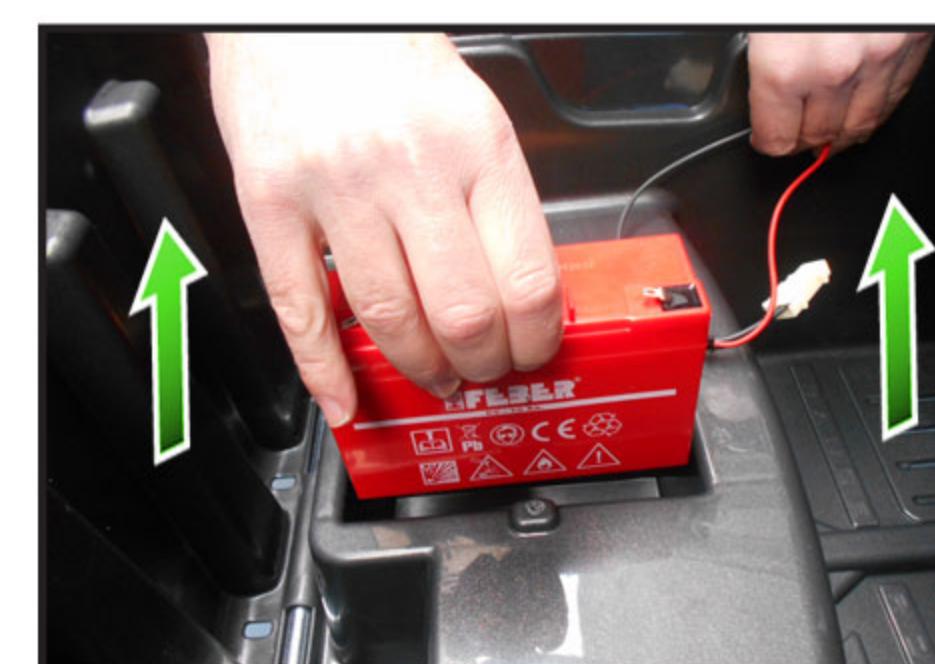

5. Remove the battery and replace with a new one. Re-assemble in reverse order and pay attention to connecting the wires to the proper polarity.

## Replacement of the circuit breaker



1. Unscrew the 2 screws from the seat.

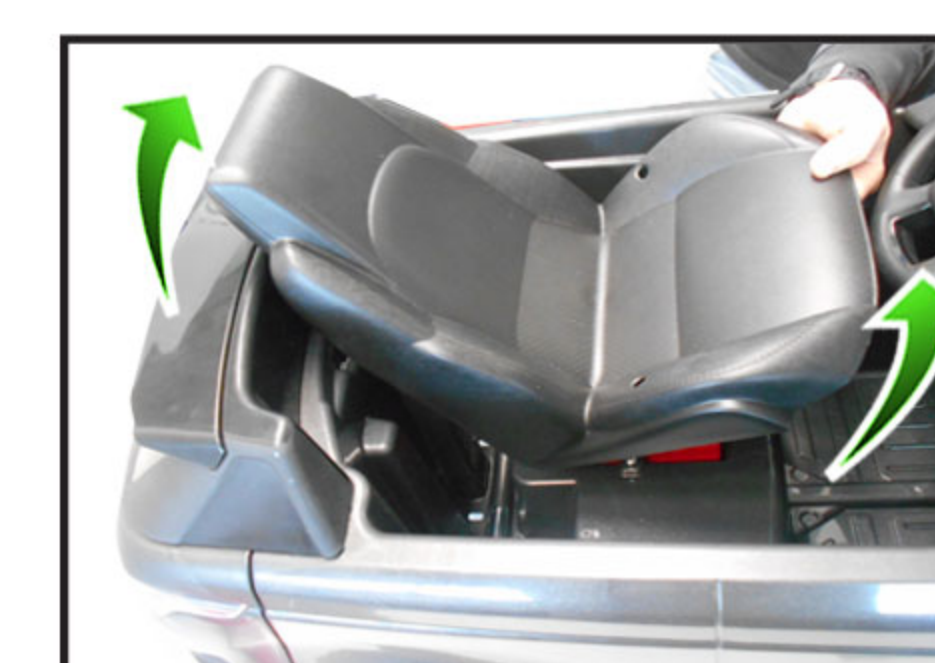

2. Remove the seat.

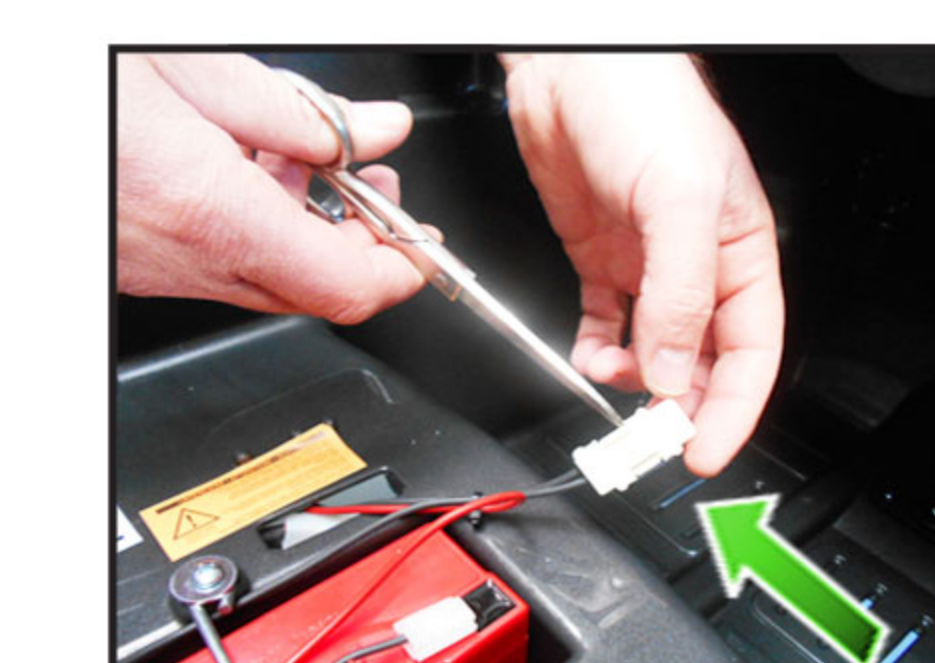

3. Remove the white cover of the circuit breaker.

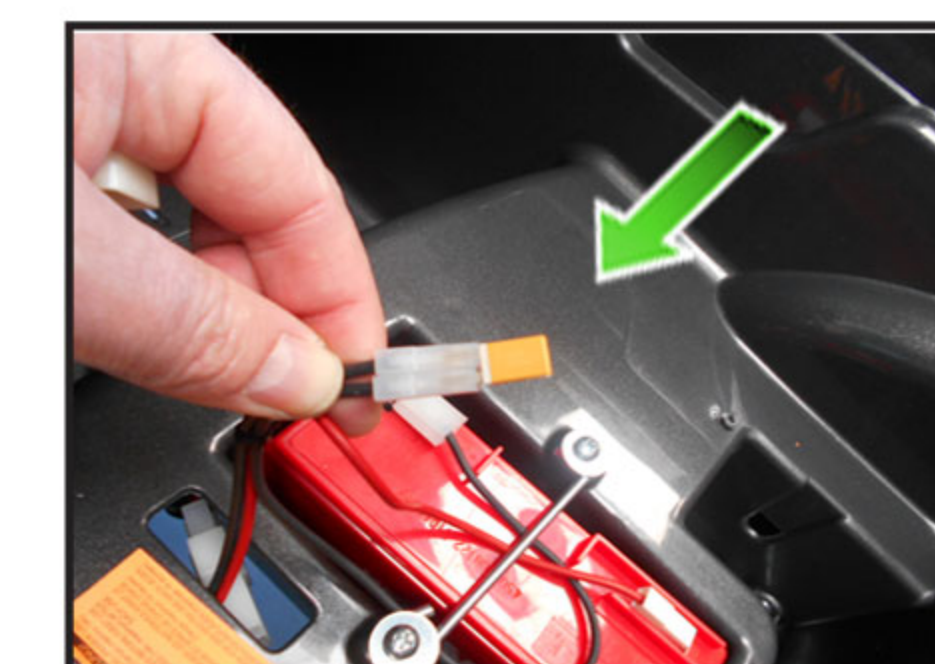

4. Remove the circuit breaker and replace with a new one..

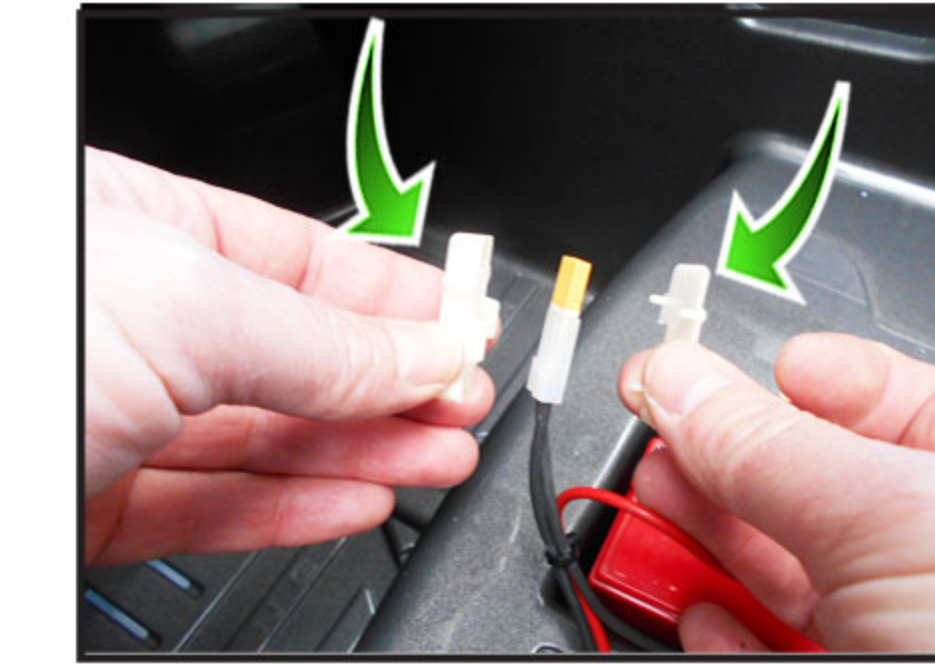

5. Fasten the white cover and re-assemble in reverse order.

## Replacement of the charge wiring



1. Unscrew the 2 screws from the seat.



2. Remove the seat

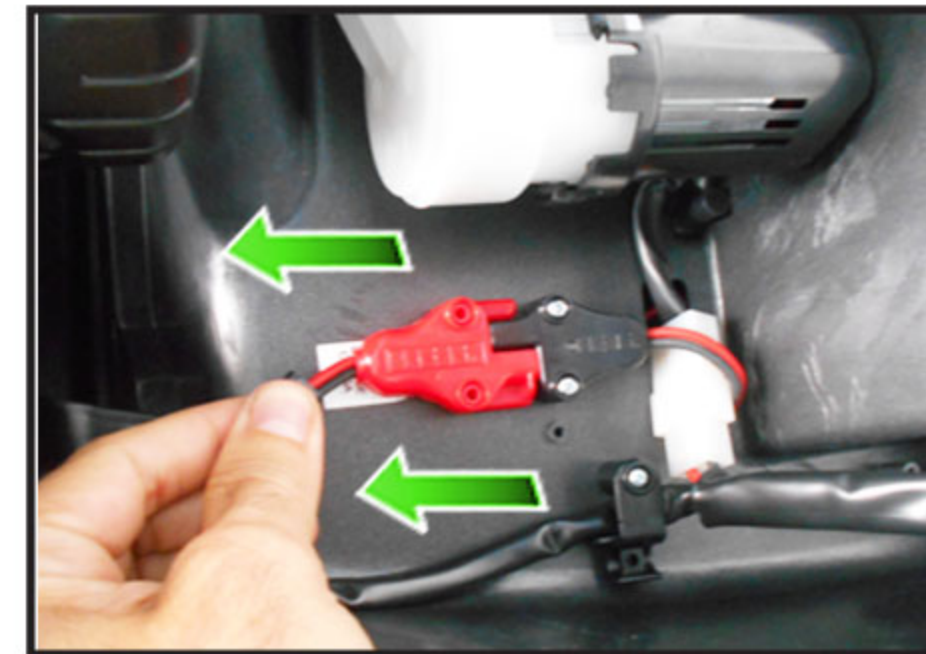

3. Turn 180° and disconnect the red wire.

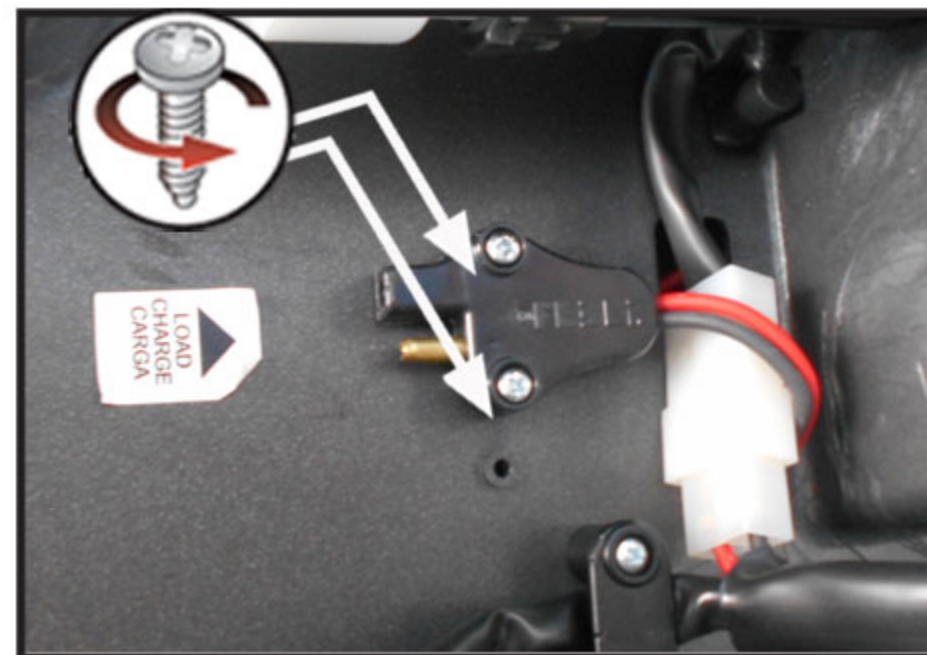

4. Unscrew the black wire.



5. Put the black wire into the hole.

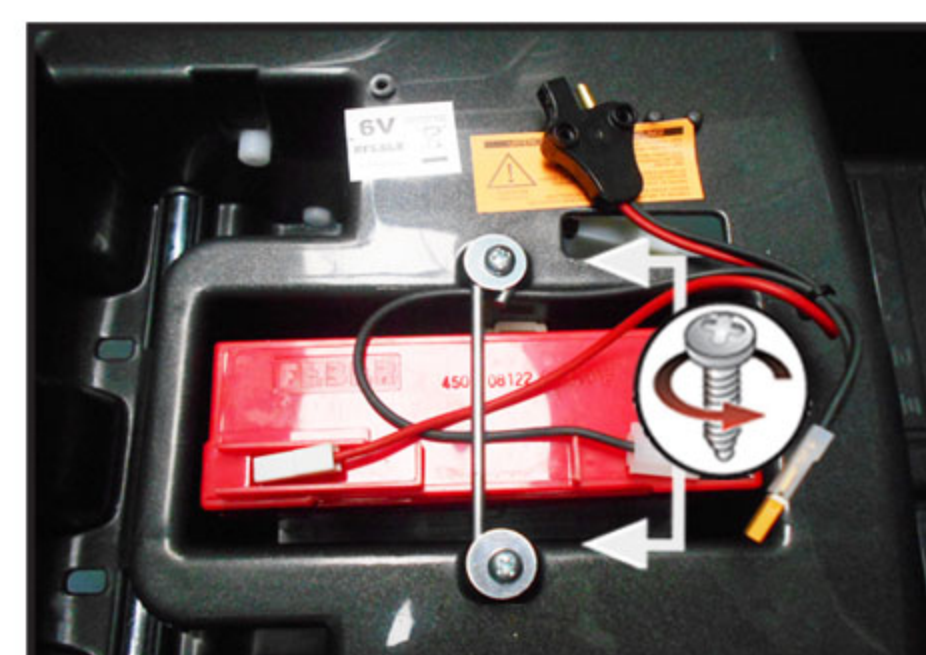

6. Unscrew the axle from the battery.



7. Disconnect the wires from the battery.



8. Replace the wires and re-assemble in reverse order.

Note: Pay attention TO connecting the wires to the proper polarity marked on the battery.

## Replacement of the gear switch

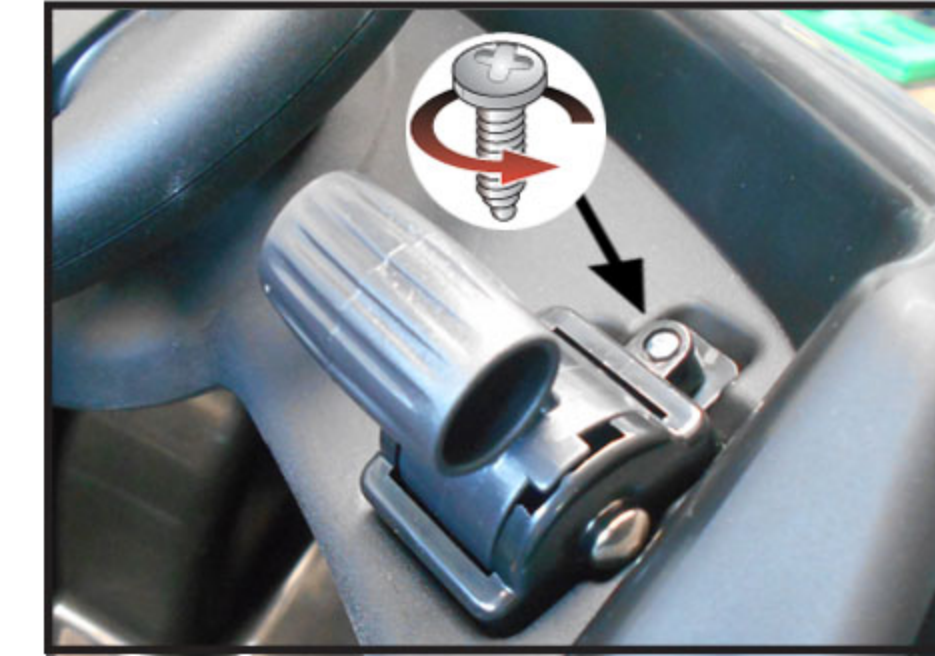

1. Unscrew the gear stick.



2. Remove the switch

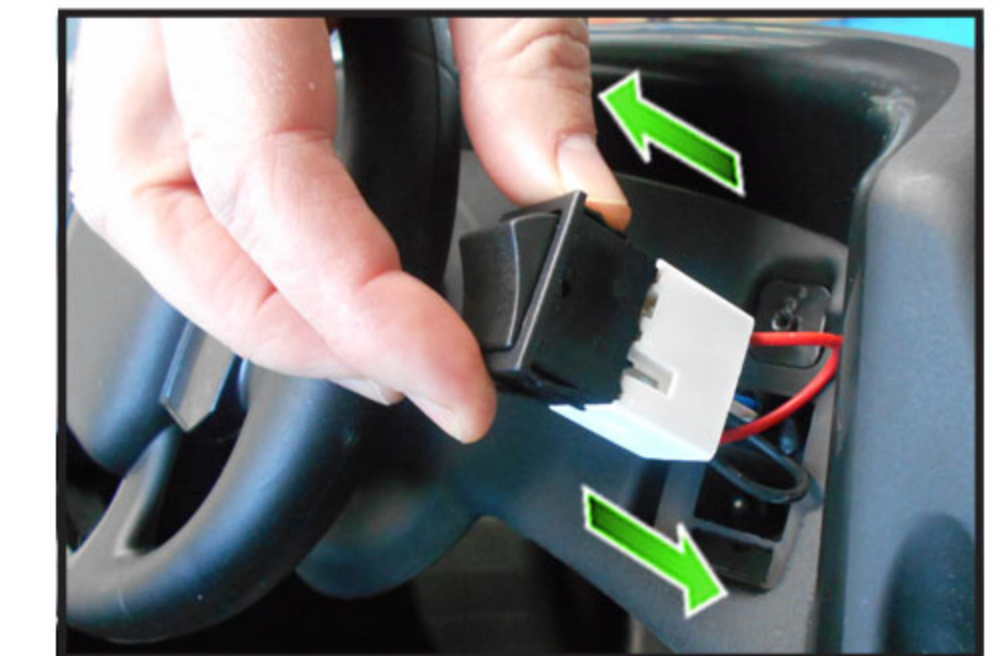

3. Disconnect the switch and replace it with a new one. Re-assemble in reverse order. Pay attention to connecting the button switch and the accelerator in the correct way.

## Replacement of the button switch



1. Unscrew the 2 screws.



2. Remove the black piece.



3. Remove the accelerator button.



4. Disconnect the wires and replace it with a new one. Re-assemble in reverse order.

Note: Pay attention to connecting the button switch and the accelerator in the correct way.